

KS01 Series Key Switch Reed Sensor



*Key and Housing are separate pieces

Key Features:

- ✓ Noncontact activation between key and sensing element
- ✓ Plastic casing ensures no corrosion damage and operation in dusty environments

Key Markets/Applications:

- ✓ Industrial Cleaning Equipment, Recreational Electric Vehicles, Security Panel, Machine Controls
- ✓ Electric Equipment, Industrial Equipment, Security, & Others



Electrical Specifications:

Contact Data	Switch Model			Unit
	1A88	1A66	2A66	
Rated Power (max.) <small>Any DC combo of V&A not to exceed individual max.'s</small>	100	10	10	W
Switching Voltage (max.) <small>DC or peak AC</small>	1000	200	200	V
Switching Current (max.) <small>DC or peak AC</small>	1.5	0.5	0.5	A
Carry Current (max.) <small>DC or peak AC</small>	6	1.0	1.0	A
Contact Resistance (max.) <small>@ 0.5V & 50mA</small>	100	150	150	mOhm
Breakdown Voltage (min.) <small>According to EN60255-5</small>	3	0.2	0.2	kVDC
Operating Time (max.) <small>Incl. Bounce; Measured with w/ Nominal Voltage</small>	0.6	0.5	0.5	ms
Release Time (max.) <small>Measured with no Coil Excitation</small>	0.1	0.1	0.1	ms
Insulation Resistance (typ.) <small>Rh<45%, 100V Test Voltage</small>	10 ¹⁰	10 ¹⁰	10 ¹⁰	Ohm
Capacitance (typ.) <small>@ 10kHz across open Switch</small>	0.5	0.2	0.2	pF
Resonant Frequency (typ.) <small>@ 10kHz across open Switch</small>	4.1	5	5	kHz
Cable Rated Voltage (max.) <small>FLRY-B Cable Rating</small>	50 (25)	50 (25)	50 (25)	VDC (VAC)

*Load increase reduces life expectancy of Reed Switches

Customer Options:



Part Number Example:

KS01 - 1A66 - 100W

SERIES 1 2 3

CUSTOMER OPTIONS

- CONTACT QUANTITY AND SWITCH MODEL [1A88, 1A66, 2A66]
- CABLE LENGTH
- TERMINATION W=STRIPPED/TINNED

Additional Options

- + Sensor comes with Nylon Ultramid A3K Key
- + Key handle and keying feature is customizable for customer owned designs
- + Tooling charges may apply for adjustments to keying features, customizations, and keys supplied by Standex.

Contact Form Glossary :

Form A

NO = Normally Open Contacts
SPST = Single Pole Single Throw



Form B

NC = Normally Closed Contacts
SPST = Single Pole Single Throw



Form C

Changeover
SPDT = Single Pole Double Throw



KS01 Series Key Switch Reed Sensor

DATA SHEET

Mechanical/Environmental Specifications:

Housing and Lead Data		
Housing and Key Material	Ultramid A3K	
Case Color	Black	
Sealing Compound	Polyurethane	
Cable Type	FLRY-B	
Cable Material	PVC	
Cross Section (mm ²)	0.5	
Environmental Data		Unit
Shock Resistance	50	g
<small>½ sine wave duration 11ms</small>		
Vibration Resistance (max.)	20	g
Operating Temperature	-40 to 80	°C
Storage Temperature	-55 to 80	°C

Lifecycles:

	Form Factor	
	1A88	1A66
Load Condition	48V @ 1.5A	20V @ 0.5A
Number of Operations	10 ⁵	10 ⁶

Handling/ Assembly Instructions:

- Through hole panel mount with D Flat
- Customer is responsible for M16 x 1.5 mounting nut
- Series resistor recommended for > 5m cable length

Dimensions (mm):

Tolerances acc. to DIN ISO 2768-m

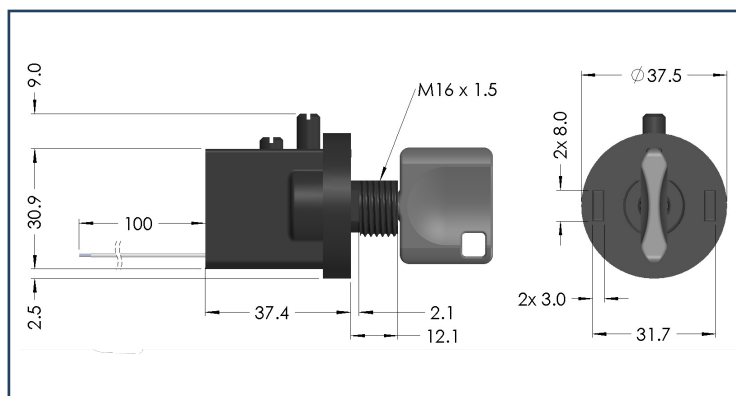

Key Position/Activation:

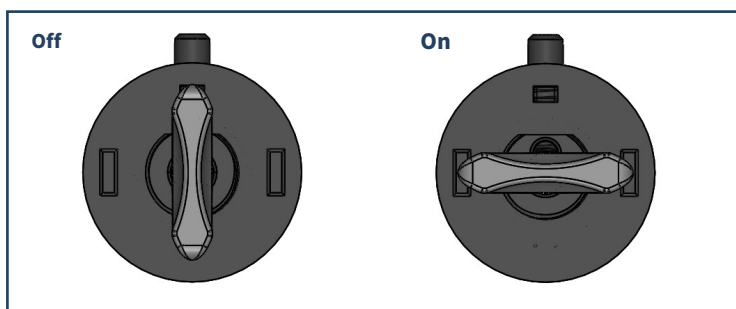

Mounting Geometry:

D Shape Cutout

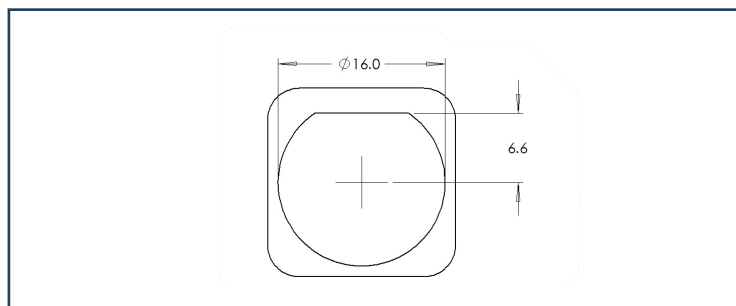

Layout:

Contact Form 1A	Black	Black
Contact Form 2A	Black	Black
	White	White